

20K Rigid Lances Advanced Pressure Systems proudly offers a growing line of quality rigid lances every pressure and application. These are 304 Stainless Steel. When ordering, please specify left or right hand thread, length and thread size.



Part #	Connection	I.D. & O.D.
51-000-XXX	1/4" MP	.247 OD x .109 ID
51-001-XXX	3/8" MP	.370 OD x .203 ID
51-002-XXX	9/16" MP	.557 OD x .312 ID

20K Carbon Steel Rigid Lances Advanced Pressure Systems now offers quality rigid lances in aircraft quality seamless 4130 steel. When ordering, please specify left or right hand thread, length and thread size.

Part #	Connection	I.D. & O.D.
45-003-XXX	1/4" MP	.247 OD x .109 ID
45-004-XXX	3/8" MP	.370 OD x .203 ID
45-005-XXX	9/16" MP	.557 OD x .312 ID

20K Flex Lance Stingers/Nipples Advanced Pressure Systems offers a growing line of quality flex lance stingers for every pressure and application. Stingers and nipples are offered in 304 stainless steel. Non-standard lengths and right-hand threaded nipples are available upon request. When ordering, please specify length and thread size.

Part #	Thread	Length, In.
21-020-003	1/4" MP	3"
21-020-006	1/4" MP	6"
21-020-008	1/4" MP	8"
21-020-010	1/4" MP	10"
21-020-012	1/4" MP	12"
21-020-024	1/4" MP	24"
21-020-036	1/4" MP	36" (3 Ft.)
21-020-048	1/4" MP	48" (4 Ft.)
21-021-003	3/8" MP	3"
21-021-006	3/8" MP	6"
21-021-008	3/8" MP	8"
21-021-010	3/8" MP	10"
21-021-012	3/8" MP	12"
21-021-024	3/8" MP	24"
21-021-036	3/8" MP	36" (3 Ft.)
21-021-048	3/8" MP	48" (4 Ft.)

Part #	Thread	Length, In.
21-022-003	9/16" MP	3"
21-022-006	9/16" MP	6"
21-022-008	9/16" MP	8"
21-022-010	9/16" MP	10"
21-022-012	9/16" MP	12"
21-022-024	9/16" MP	24"
21-022-036	9/16" MP	36" (3 Ft.)
21-022-048	9/16" MP	48" (4 Ft.)
21-022-060	9/16" MP	60" (5 Ft.)
21-023-006	3/4" MP	6"
21-023-008	3/4" MP	8"
21-023-010	3/4" MP	10"
21-023-012	3/4" MP	12"
21-023-048	3/4" MP	48" (4 Ft.)
21-024-006	1" MP	6"
21-024-008	1" MP	8"
21-024-010	1" MP	10"
21-024-012	1" MP	12"
21-024-024	1" MP	24"
21-024-036	1" MP	36" (3 Ft.)
21-024-048	1" MP	48" (4 Ft.)



STAINLESS STEEL AND CARBON STEEL RIGID LANCE, STINGERS & PIPE NIPPLES

LANCE ACCESSORIES

20K Rigid Lance Holder The threaded end of a rigid lance where it connects directly to a manifold is its weakest point. A break at this threaded connection renders an otherwise good lance unusable.



The **Advanced Pressure Systems Rigid Lance Holder** provides full support to the lance at a point well in front of the thread. This Lance Holder is designed to be the best available on the market. It uses a collet and lock nut of the same design as used for a machine shop lathe, which provides a vise like grip on the lance, completely relieving stress on the thread.

Installation or removal of the lance is very easily accomplished: Simply slide the End Cap, Collet and Lance Holder Support Tube onto the lance in that order and then screw the lance into the Lance Holder body. The Lance Holder Tube is then screwed into the Body and then the Collet is secured into the Lance Holder Tube by the End Cap. The lance will then be fully supported.

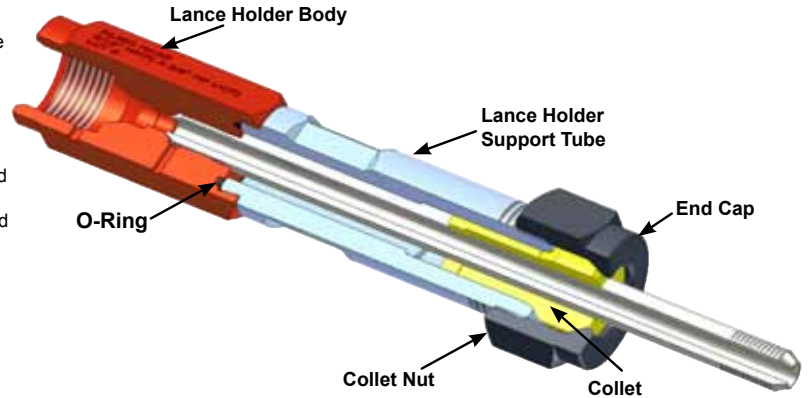

Part #	20K Lance Holders Description	PSI/Bar
21-030-001	Lance Holder Assy. 9/16" MP (F) x 1/4"-28 RH (F)	20K/1379
21-030-002	Lance Holder Assy. 9/16" MP (F) x 3/8"-24 RH (F)	20K/1379
21-030-003	Lance Holder Assy. 9/16" MP (F) x 9/16"-18 RH (F)	20K/1379
21-030-004	Lance Holder Assy. 9/16" MP (F) x 1/4"-28 LH (F)	20K/1379
21-030-005	Lance Holder Assy. 9/16" MP (F) x 3/8"-24 LH (F)	20K/1379
21-030-006	Lance Holder Assy. 9/16" MP (F) x 9/16"-18 LH (F)	20K/1379

Flex Lance Safety Grip The **FLEX LANCE SAFETY GRIP** is designed to minimize the risk of injury to flex lance operators caused by a live nozzle exiting the tube unexpectedly. The comfortably contoured handle makes it easy to hold the **SAFETY GRIP** against the tube sheet, allowing retraction of an active nozzle into a stainless steel sleeve where the force of the jets is dissipated.

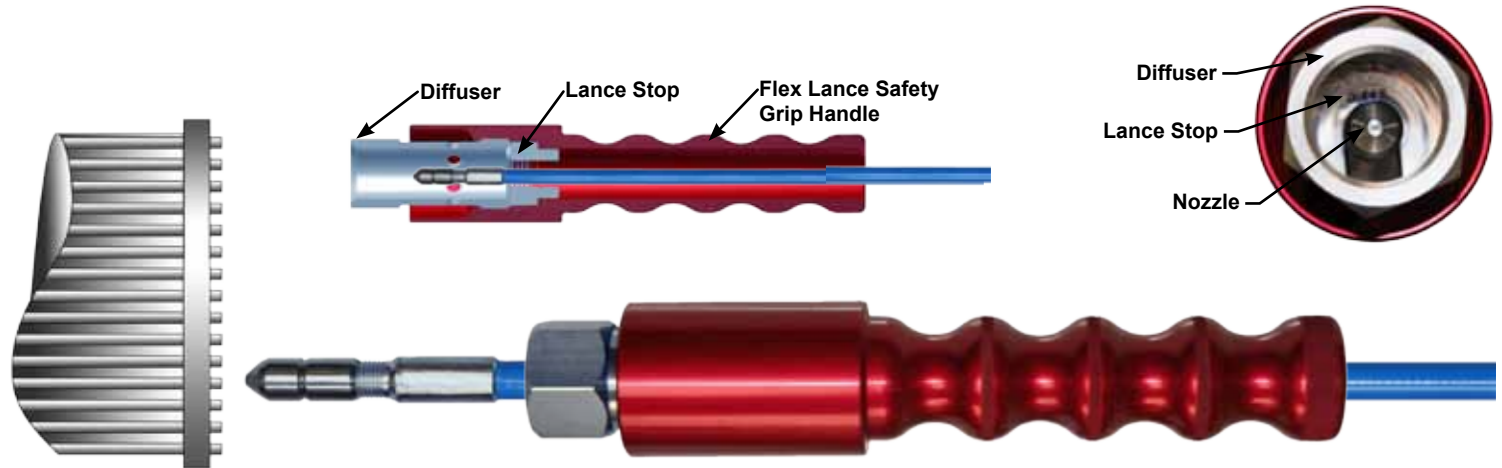

The **FLEX LANCE SAFETY GRIP** is simple to install and is quickly adapted to handle various lance sizes by selecting the appropriately sized **LANCE STOP**.

Part #	Flex Lance Safety Grip
35-009-000	COMPLETE ASSEMBLY: Small Flex Lance Safety Grip*
35-009-001	HANDLE: Small Flex Lance Safety Grip
35-009-007	DIFFUSER: Small Flex Lance Safety Grip

Installation of LANCE STOPS: Simply unscrew the **DIFFUSER** from the **SAFETY GRIP HANDLE**, which will allow the **LANCE STOP** to be removed. Insert the new lance into the back of the **SAFETY GRIP HANDLE**. Select the correct size **LANCE STOP** for the lance to be used and place it onto the lance behind the nozzle end fitting. Insert the nozzle through the **DIFFUSER** and tighten the assembly into the **HANDLE**. (Note: the larger diameter end of the Lance Stop must be next to the end fitting.)



Part #	Lance Stop Description
35-009-002	Stop .323 Flex Lance Safety Guard Lance
35-009-003	Stop .390 Flex Lance Safety Guard Lance
35-009-004	Stop .442 Flex Lance Safety Guard Lance (2005 Lance)
35-009-005	Stop .510 Flex Lance Safety Guard Lance (2006 Lance)
35-009-006	Stop .725 Flex Lance Safety Guard Lance (2108 Lance)
35-009-010	Stop .290 Flex Lance Safety Guard Lance (3/2 & 3004 Lance)
35-009-011	Stop .530 Flex Lance Safety Guard Lance (6005 Lance)
35-009-012	Stop .570 Flex Lance Safety Guard Lance (1/4" NPT & 9/16" Rigid Lance Size)
35-009-013	Stop .470 Flex Lance Safety Guard Lance (4005 Lance)
35-009-014	Stop .870 Flex Lance Safety Guard Lance

Articulated Flex Lance Safety Stop For Tube Sheet Mounting

This takes the Hand Held "Flex Lance Safety Grip" to the next level. This versatile lance stop/anti-withdrawal device attaches easily to the tube sheet for safer pipe cleaning operations. It features ready adaptability to vertical or horizontal applications and its wide range of expansion accommodates any size of tube sheet. Construction is galvanized steel with aluminum handles and includes a Lexan® splash guard.

The stops for six sizes of lances are provided by a quick-change insert, which is built into the design. This eliminates the problem of lost lance stops and makes changing to a different lance diameter quick and easy.

Change of Lance Stop Size:

1. Unscrew Cover.
2. Open Lance Stop Retainer Latch.
3. Pull out Lance Stop Insert
4. Feed lance into Support Tube.
5. Select Stop size and install Insert.
6. Close Latch and replace Cover.

MULTI-LANCE STOP ASSEMBLY
Part No. 36-015-082-1

ITEM	QTY	PART #	DESCRIPTION
1	1	36-015-026	Chicken Wing Mounting Plate
2	1	36-015-025	Clutch Mounting Plate
3	1	10-121-350	Hex. Head Bolt 5/8"-11 x 3-1/2" long
4	2	36-015-046	Limiter - AWD Modified Torque
5	2	36-015-034	Bearing - Torque Limiter
6	4	36-015-016	Pivot Mounting Plate
7	4	36-015-033	Torque Limiter Fiber Washer
8	1	36-015-018	Telespar Arm
9	2	36-015-035	Torque Limiter Spacer (Orange)
10	2	36-015-032	Spring Washer
11	2	36-015-023	Spacer for Torque Limiter
12	2	36-015-028	Handle
13	1	36-015-068	Pivot Pin & Locking Plate Assembly
14	1	36-015-019	Telespar Arm
16	1	36-015-027	Extension Locking Pin
18	4	10-015-250	Hex. Head Bolt 5/16"-18 x 2-1/2" long
19	5	10-100-003	Nylon Lock Nut 5/16"-18 SS
20	4	10-002-050	SHCS 5/16"-18 x 1/2" long SS
26	1	36-015-088	New Telespar Extension Arm
27	1	36-015-082-1	Multi-Lance Stop Assembly
28	1	10-015-150	Hex. Head Bolt 5/16"-18 x 1-1/2" long

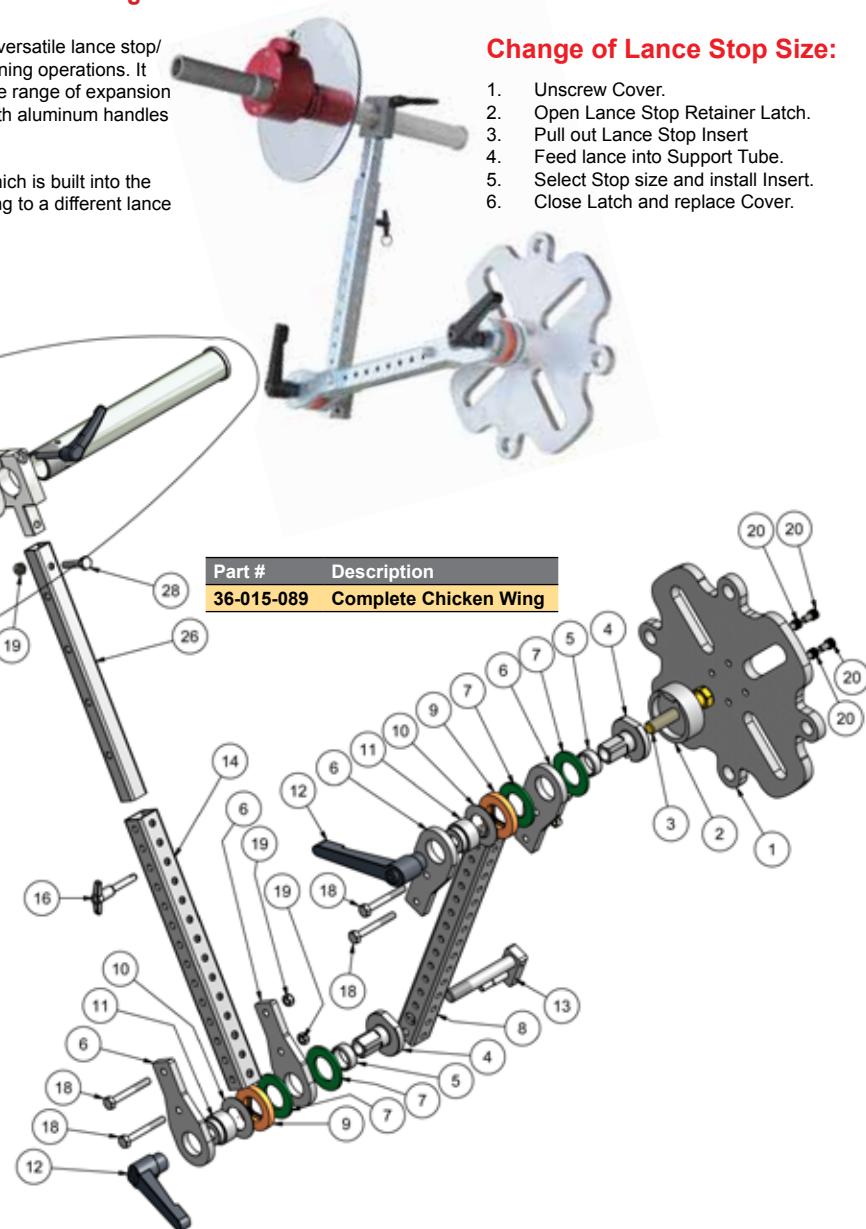

ITEM	QTY	PART #	DESCRIPTION
1	1	36-015-070	Lance Stop Body - Part 1
2	1	36-015-072	Lance Stop Body - Part 2
3	1	36-015-073	Lance Guide Tube
4	1	36-015-071	Latch - Lance Stop Holder
5	1	36-015-074	Latch Bolt
6	2	36-015-080	Dowel Pin
7	1	36-015-007	Lance Stop Insert
8	1	36-015-069	Clamp (new Style)
9	1	36-015-044	Splash Shield (1.5" Size)
10	2	30-001-127	O-Ring
11	1	36-015-031	Handle
12	1	36-015-075	Wing Nut
13	5	10-001-125	SHCS 1-1/4" long SS
14	1	36-015-077	Latch Pivot Pin
15	1	36-015-078	Retaining Clip
17	1	36-015-081	Extension Tube Holder
18	1	36-015-084	Splash Shield Retaining Ring
19	1	10-121-150	Retaining Clip (5100-150) SS
20	1	36-015-087	Extension Tube

